

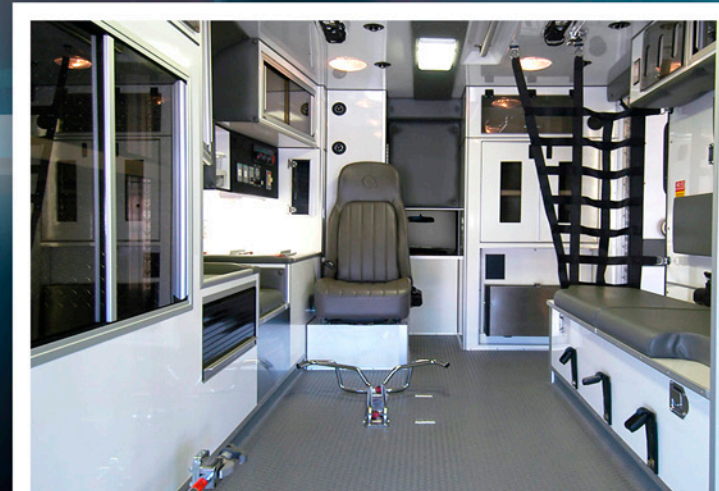

AMERICAN EMERGENCY  
VEHICLES



TYPE I F350 / 450 / 550



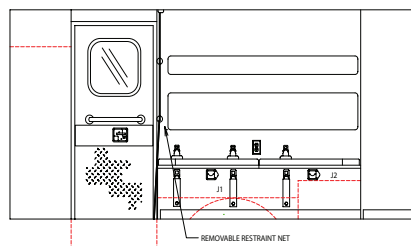
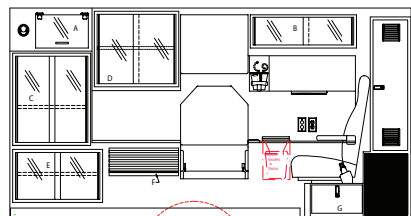
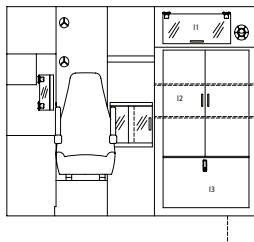
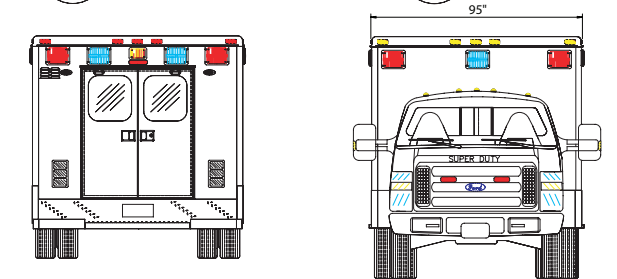
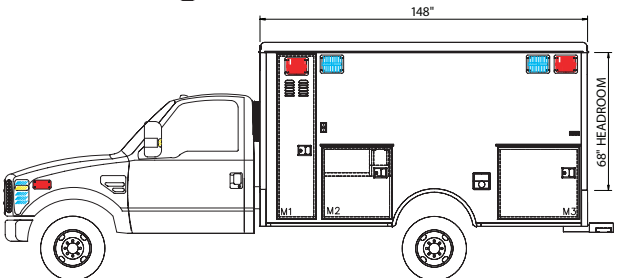
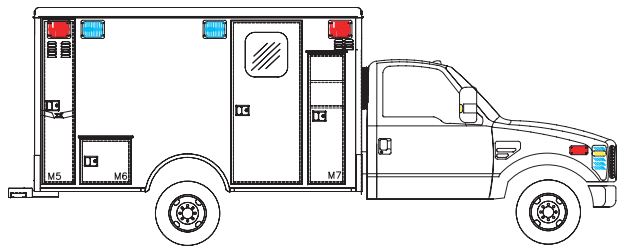

# TYPE I F350 / 450 / 550



## CHASSIS

- Ford F-Series, Turbo Diesel / High Trim Level / 47A Ambulance Prep Package
- 6.4 Turbo Diesel Engine
- 4R100 Electronic Transmission
- Dual OEM Alternator
- Engine Block Heater
- HVAC Hook Ups Under Body
- Electric Door Locks
- High Trim Level
- Dual Batteries Under Hood

## CONVERSION

- |  |  |  |   |
|--|--|--|---|
| <p>Conversion*<br/>Module<br/>Attendant Seat<br/>Batteries<br/>Battery Switch<br/>Backboard Storage<br/>Back Up Alarm<br/>Biowaste System<br/>Bumper, Rear<br/>Cabinet, Action Area<br/>Cabinet, Bench Lid<br/>Cabinet, CPR Seat<br/>Cabinet, Electrical<br/>Cabinet, Laminate<br/>Cabinet, Polycarbonate<br/>Cabinet, RF<br/>Cabinet, Tambour Doors<br/>Coax Cables<br/>Compartment, Lining<br/>Compartment, Shelves<br/>Compartment, Straps</p> <p>Console<br/>Cot Mount<br/>Door Hold Opens<br/>DOT Package<br/>Drip Rails<br/>Electrical System<br/>Electrical Wiring<br/>Fasteners, Exterior<br/>Fender Flares<br/>Flooring<br/>Flooring, Roll Up<br/>Fuel Fill<br/>Ground Straps<br/>Handles, Interior<br/>Headliner<br/>Heat-AC</p> | <p>TraumaHawk, High Trim<br/>148" x 95" x 68" Interior Headroom<br/>Captain's Chair on Storage Box<br/>(2) Underhood<br/>Cole Hersee 2484-16<br/>Right Rear Compartment, Vertical<br/>With Auto Reset<br/>Streetside<br/>Treadplate, with Center Flip Up Section<br/>Formed ABS, Fixed in Place<br/>Split Lid<br/>Streetside with Telemetry Area<br/>Behind Attendant Seat<br/>Choice of Optional Colors<br/>Gray Tinted or Clear with Full Handles<br/>Wood Doors with Inside/Outside Access<br/>(1) Total in Patient Area<br/>(1) Tagged at Both Ends<br/>Diamond Plate<br/>(1) Total Aluminum in Exterior Compartment<br/>(1) Total in Right Rear Compartment<br/>for Backboards<br/>Wood Between Cab Seats<br/>Stryker<br/>Grabbers on Rear Doors<br/>Shipped Loose<br/>Bright Finish Aluminum<br/>Printed Circuit Board with LED Diagnostics<br/>Color, Name &amp; Number Coded<br/>AVK for Attachment of Door Panels<br/>Aluminum<br/>Choice of Optional Colors<br/>3" Recessed<br/>Aluminum Housing<br/>(4) with Star Washers<br/>Handicap Style on all Entry Doors<br/>(1) Piece Front to Rear, Gloss White<br/>Ceiling Ducted</p> | <p>Insulation<br/>IV Hooks<br/>KKK Package<br/>License Plate Holder<br/>Lights, Action Area<br/>Lights, Clearance<br/>Lights, Dome<br/>Lights, Handheld Spotlight<br/>Lights, Indicator</p> <p>Lights, Load<br/>Lights, Scene<br/>Lights, Side Marker<br/>Lights, Tail<br/>Lights, Third Brake<br/>Lights, Warning Package<br/>Outlets, 115vac<br/>Outlets, 12vdc<br/>Overhead Grabrail<br/>Oxygen Cylinder Rack<br/>Oxygen Outlets<br/>Paint<br/>Paint Belt<br/>Patient Floor<br/>Reflectors<br/>Shoreline<br/>Siren<br/>Siren Speaker<br/>Skirtrails<br/>Suction System</p> <p>Undercoat<br/>Upholstery<br/>Wheel Covers<br/>Windows, C/S Upper<br/>Windows, Pass Thru<br/>Windows, Rear Upper</p> | <p>Reflectix Circumferential Package<br/>(2) Perko Hooks Installed Overhead<br/>To Present Revision<br/>Recessed in Rear Kickplate<br/>12vdc Fluorescent<br/>LED On Front &amp; Rear<br/>(6) Total, Halogen<br/>400,000CP Blue Eye<br/>Door, Compartment Ajar, &amp; Battery<br/>on Cab Console<br/>(2) Whelen on Rear<br/>(2) Whelen on Each Side<br/>On Sides of Body<br/>Triple Light Cluster on Rear<br/>Mounted over Rear Doors<br/>Whelen Perimeter Lighting<br/>(2) Total (1) Curbside (1) Streetside<br/>(2) Cigar Style Outlets<br/>72" with Rounded Ends, Recessed<br/>Aluminum Rack, LF Compartment<br/>(2) Total , Ohio Style<br/>OEM Polar White<br/>Single Belt<br/>Plywood, Full Length &amp; Width, Insulated<br/>(6) Total, (4) Rear &amp; (2) Front<br/>15 Amp Inlet on Streetside<br/>Whelen WS-295<br/>Dual 100 watt<br/>Diamond Plate<br/>SSCOR with Disposable Container,<br/>Electric Pump<br/>Per QVM Guidelines<br/>Choice of Optional Colors<br/>Stainless Steel<br/>Std. Tint Fixed<br/>Sliding Lexan with Bellows<br/>Std. Tint Fixed</p> |
|--|--|--|---|

\*Base conversion shown—additional configurations and options available as part of AEV's ongoing program of product improvement. Specifications are subject to change without notice.



AMERICAN EMERGENCY VEHICLES